

### GENERAL NOTE

1. NO PART OF THIS DRAWING MAY BE SCALED. ALL DIMENSIONS ARE IN MILLIMETERS
2. ALL DRAWINGS MUST BE READ IN CONJUNCTION WITH THE ARCHITECT'S DRAWINGS
3. ALL DISCREPANCIES MUST BE REPORTED TO THE ENGINEER WITHOUT DELAY.
4. CONTRACTOR MUST CHECKED AND VERIFY ALL SETTING OUT DIMENSIONS PRIOR TO ANY WORK ON SITE.
5. THE QUALITY OF WORK AND MATERIALS MUST COMPLY WITH SABS 0162 "THE STRUCTURAL USE OF STEEL" AND SABS 1200H "STANDARDIZED SPECIFICATIONS FOR CIVIL ENGINEERING CONSTRUCTION CHAPTER 4- STRUCTURAL STEELWORK".

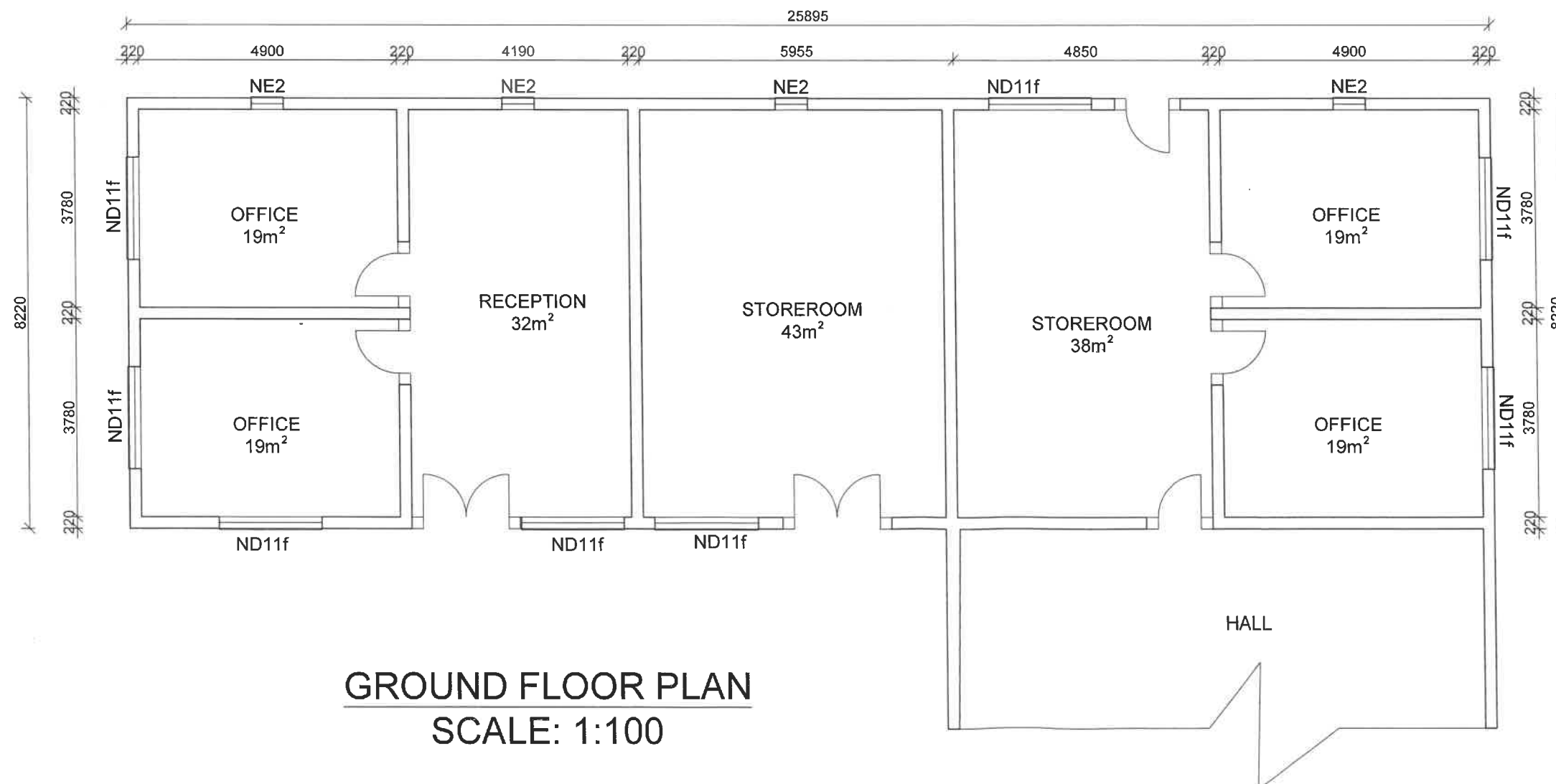

**GROUND FLOOR PLAN**  
**SCALE: 1:100**

0	28-01-2022	FOR TENDERING	S.N
No	Date	Description	Initial

<b>OHANGWENA REGIONAL COUNCIL</b>	
Address: Private Bag 88011 Eenhana Tel: +264 65 264 300 Fax: +264 65 263 033	
Designed: SHANGESHAPWAKO S.N.	Surveyed: URSAN DYNAMIC
Checked: CLARA M.	Approved by:
Drawn: CLARA M.	Approval Date: J. J. ....
Checked: SHANGESHAPWAKO S.N.	
Settlement Office: ONAMBUTU COMMUNITY HALL	
PO Box 3000000 Tel: +264 65 300000 Fax: +264 65 300000	

Project: <b>TILLING AND FITTING BURGLAR BARS ON ONAMBUTU COMMUNITY HALL</b>	
Drawing Title: <b>GROUND FLOOR PLAN</b>	
Date of Drawing: JANUARY 2022	Scale: AS SHOWN
Drawing No.: <b>OHR 2022 - ST - 001</b>	Revision: <b>A</b>
Copyright of this drawing reserved	

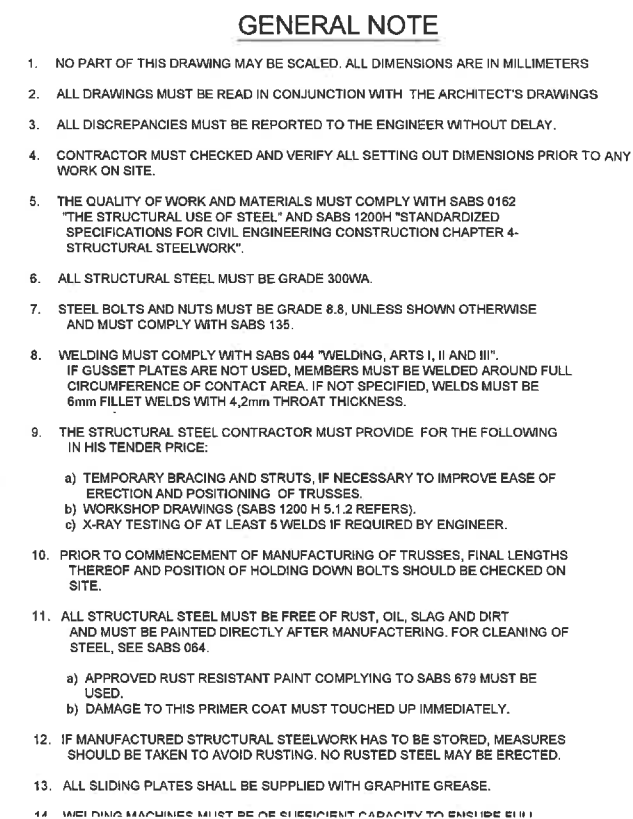

2xSCREEN GATE TYPE  
SCALE 1 : 20

## SECURITY GATE LOCK

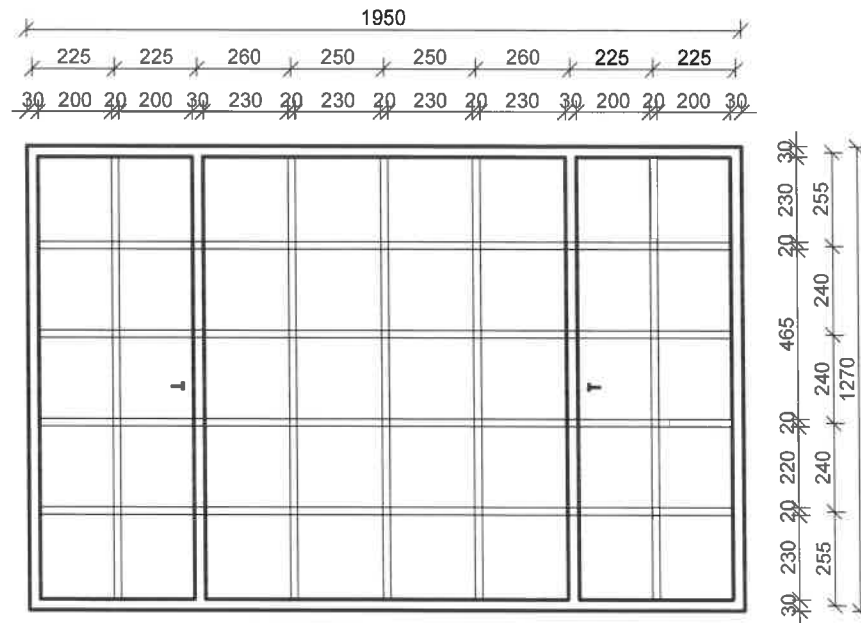

13xWINDOW BURGLAR BARS TYPE  
SCALE 1 : 20

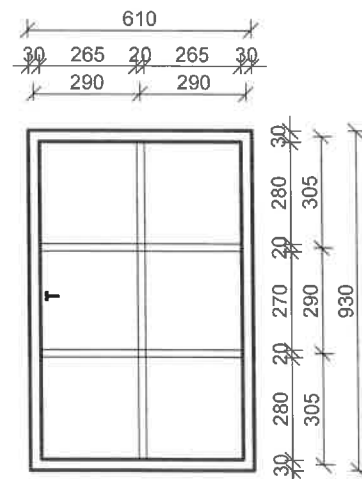

11xWINDOW BURGLAR BARS TYPE:  
SCALE 1 : 20

### GENERAL NOTE

1. NO PART OF THIS DRAWING MAY BE SCALED. ALL DIMENSIONS ARE IN MILLIMETERS
2. ALL DRAWINGS MUST BE READ IN CONJUNCTION WITH THE ARCHITECT'S DRAWINGS
3. ALL DISCREPANCIES MUST BE REPORTED TO THE ENGINEER WITHOUT DELAY.
4. CONTRACTOR MUST CHECKED AND VERIFY ALL SETTING OUT DIMENSIONS PRIOR TO ANY WORK ON SITE.
5. THE QUALITY OF WORK AND MATERIALS MUST COMPLY WITH SABS 0162 "THE STRUCTURAL USE OF STEEL" AND SABS 1200H "STANDARDIZED SPECIFICATIONS FOR CIVIL ENGINEERING CONSTRUCTION CHAPTER 4- STRUCTURAL STEELWORK".
6. ALL STRUCTURAL STEEL MUST BE GRADE 300WA.
7. STEEL BOLTS AND NUTS MUST BE GRADE 8.8, UNLESS SHOWN OTHERWISE AND MUST COMPLY WITH SABS 135.
8. WELDING MUST COMPLY WITH SABS 044 "WELDING, ARTS I, II AND III". IF GUSSET PLATES ARE NOT USED, MEMBERS MUST BE WELDED AROUND FULL CIRCUMFERENCE OF CONTACT AREA. IF NOT SPECIFIED, WELDS MUST BE 6mm FILLET WELDS WITH 4,2mm THROAT THICKNESS.
9. THE STRUCTURAL STEEL CONTRACTOR MUST PROVIDE FOR THE FOLLOWING IN HIS TENDER PRICE:
  - a) TEMPORARY BRACING AND STRUTS, IF NECESSARY TO IMPROVE EASE OF ERECTION AND POSITIONING OF TRUSSES.
  - b) WORKSHOP DRAWINGS (SABS 1200 H 5.1.2 REFERS).
  - c) X-RAY TESTING OF AT LEAST 5 WELDS IF REQUIRED BY ENGINEER.
10. PRIOR TO COMMENCEMENT OF MANUFACTURING OF TRUSSES, FINAL LENGTHS THEREOF AND POSITION OF HOLDING DOWN BOLTS SHOULD BE CHECKED ON SITE.
11. ALL STRUCTURAL STEEL MUST BE FREE OF RUST, OIL, SLAG AND DIRT AND MUST BE PAINTED DIRECTLY AFTER MANUFACTURING. FOR CLEANING OF STEEL, SEE SABS 064.
  - a) APPROVED RUST RESISTANT PAINT COMPLYING TO SABS 679 MUST BE USED.
  - b) DAMAGE TO THIS PRIMER COAT MUST TOUCHED UP IMMEDIATELY.
12. IF MANUFACTURED STRUCTURAL STEELWORK HAS TO BE STORED, MEASURES SHOULD BE TAKEN TO AVOID RUSTING. NO RUSTED STEEL MAY BE ERECTED.
13. ALL SLIDING PLATES SHALL BE SUPPLIED WITH GRAPHITE GREASE.
14. WELDING MACHINES MUST BE OF SUFFICIENT CAPACITY TO ENSURE FULL PENETRATION - 150 AMPS IS REGARDED THE MINIMUM.

No	Date	Description	Initial
1	28-01-2022	FOR TENDERING	S.N

<b>OHANGWENA REGIONAL COUNCIL</b>	
Address: Private Bag 860/1 Erongo Namibia Tel: +264 65 264 300 Fax: +264 65 263 033	
Designed: SHANGESHAPWAKO S.N	Surveyed: URBAN DYNAMIC
Checked: CLARA M	Approved by:
Drawn: CLARA M	Approval Date: ...
Checked: SHANGESHAPWAKO S.N	
Settlement Office: ONAMBUTU COMMUNITY HALL PO Box 800000 Tel: +264 65 30000 Fax: +264 65 30000	
Project: <b>TILLING AND FITTING BURGLAR BARS ON ONAMBUTU COMMUNITY HALL</b>	
Drawing Title: <b>SCHEDULE OF WINDOW BURGLAR BARS</b>	
Date of Drawing: JANUARY 2022	Scale: AS SHOWN
Drawing No: OHR 2022 - ST - 003	Revision: A